

FITTING INSTRUCTIONS

> Range Rover Sport

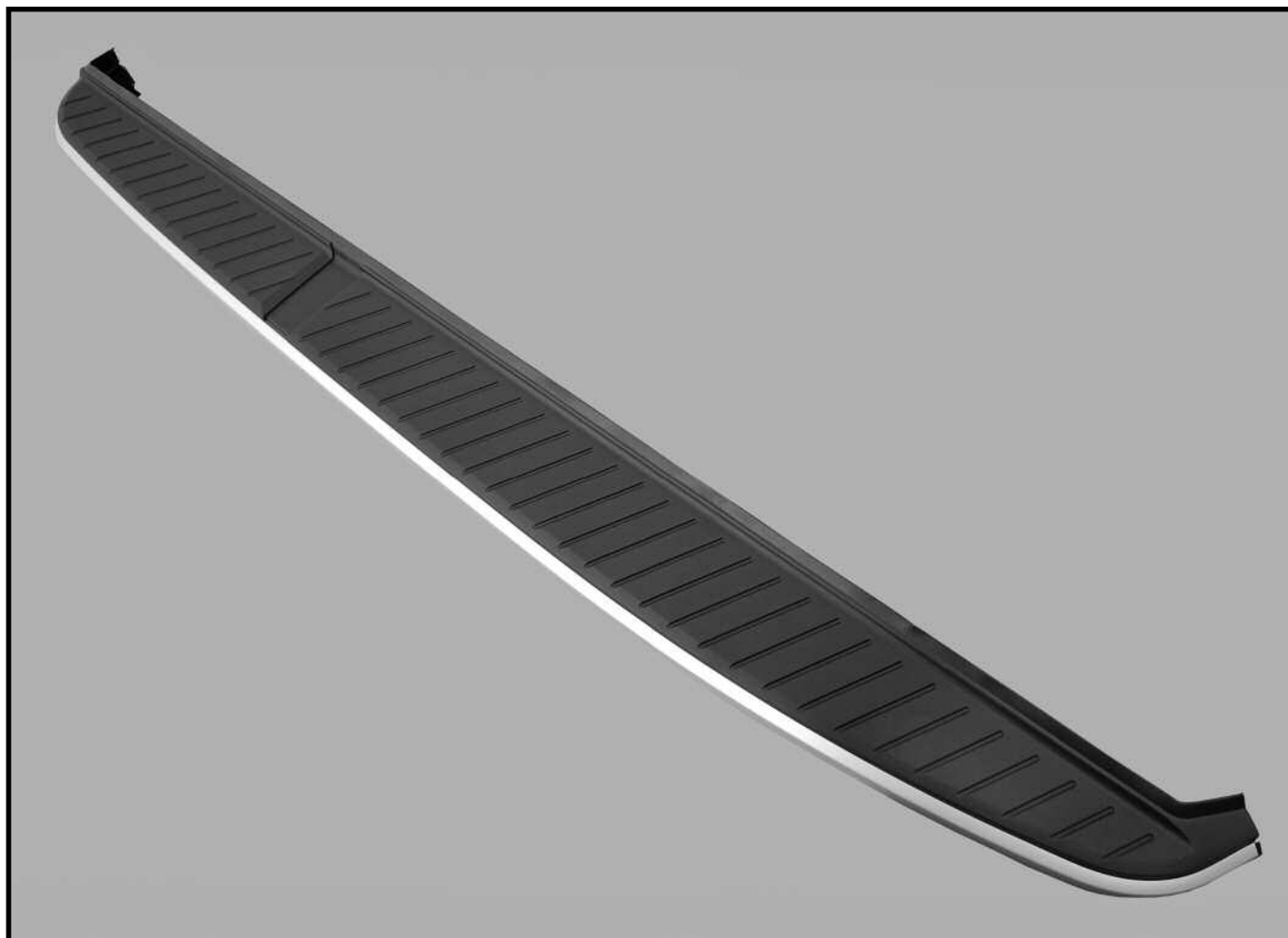

Side Steps

BRITPART

The quality parts for Land Rovers

Fitting Instructions

Range Rover Sport Side Step

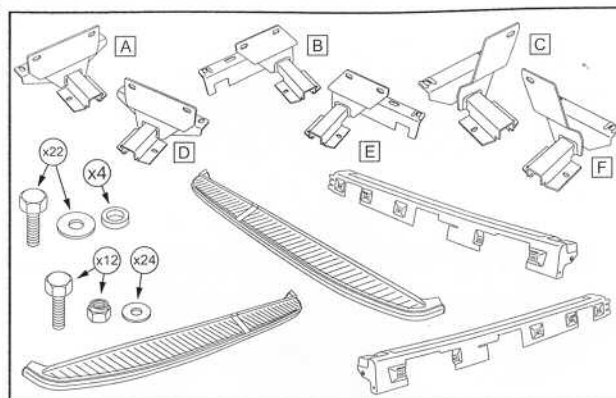
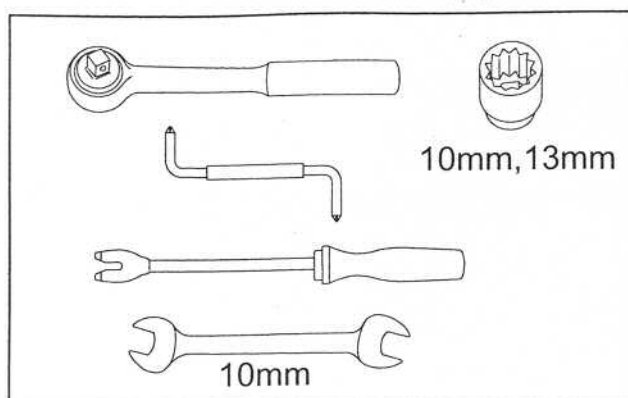

The following instructions are valid for both sides of the vehicle

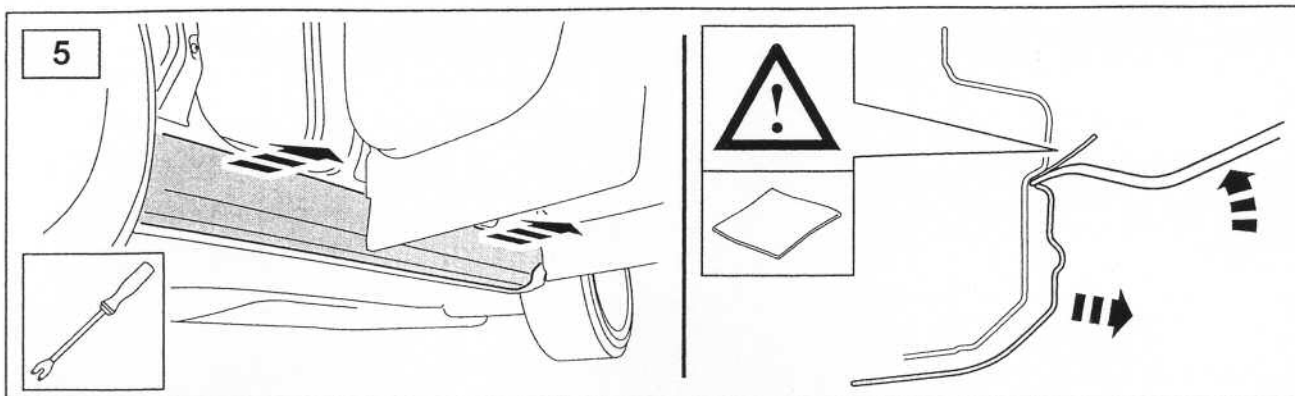
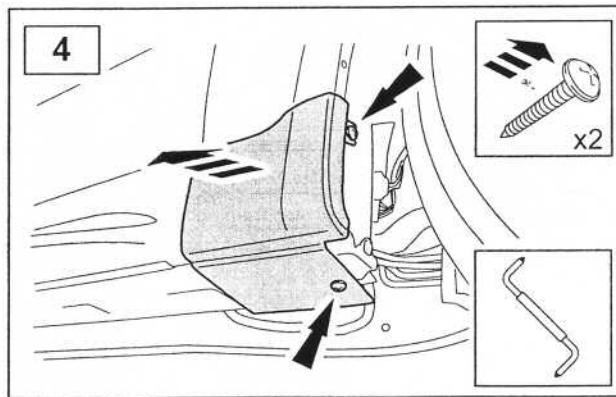
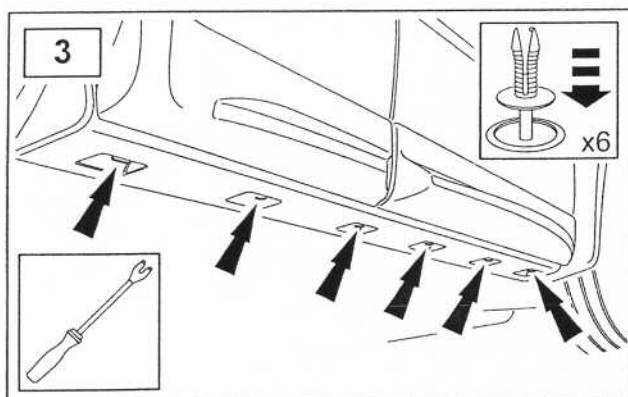
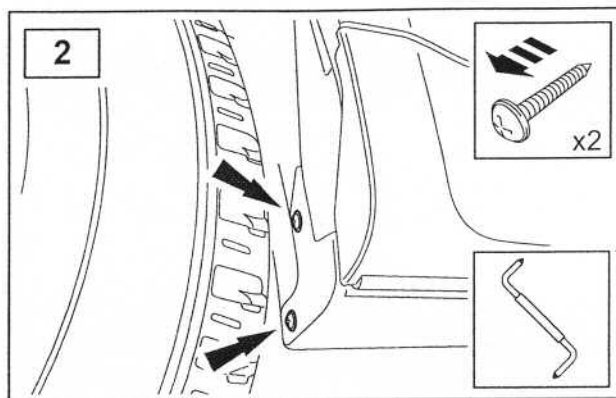
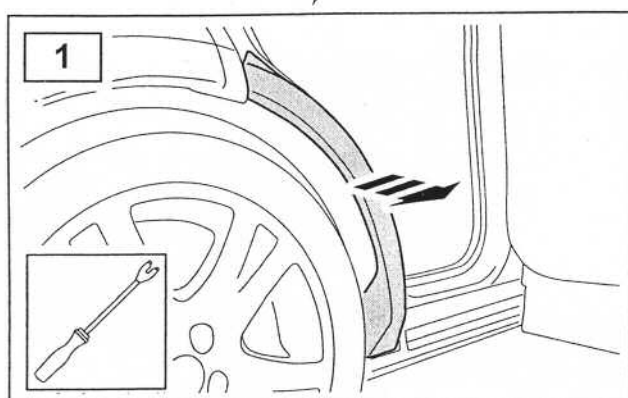

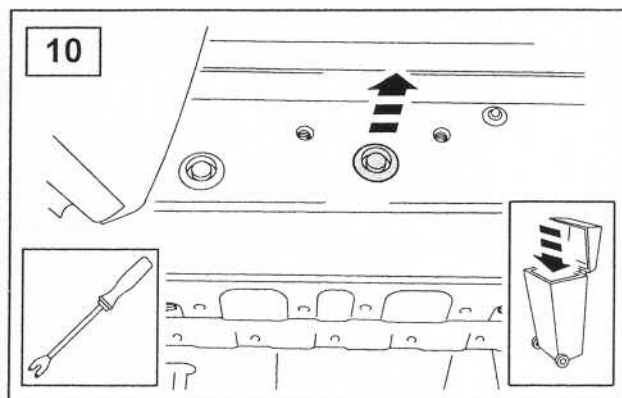
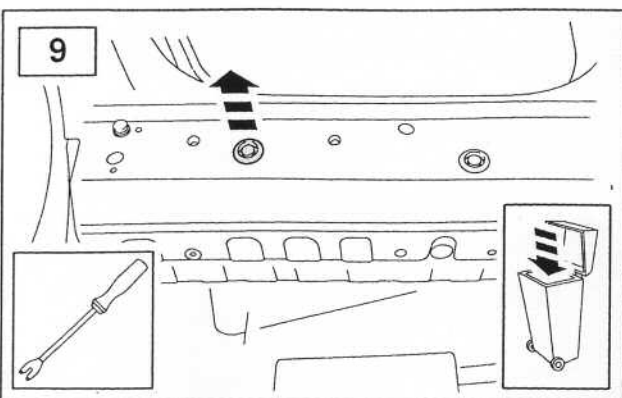
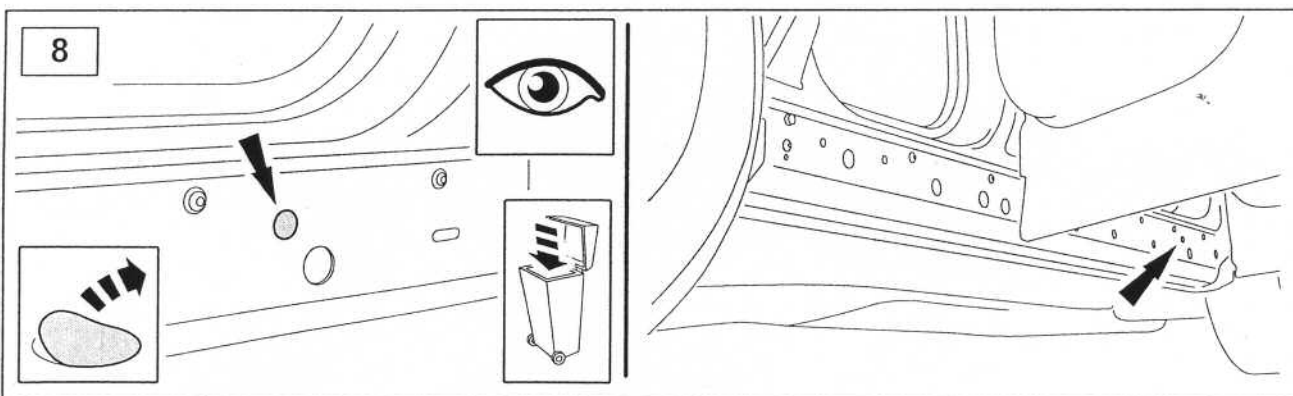
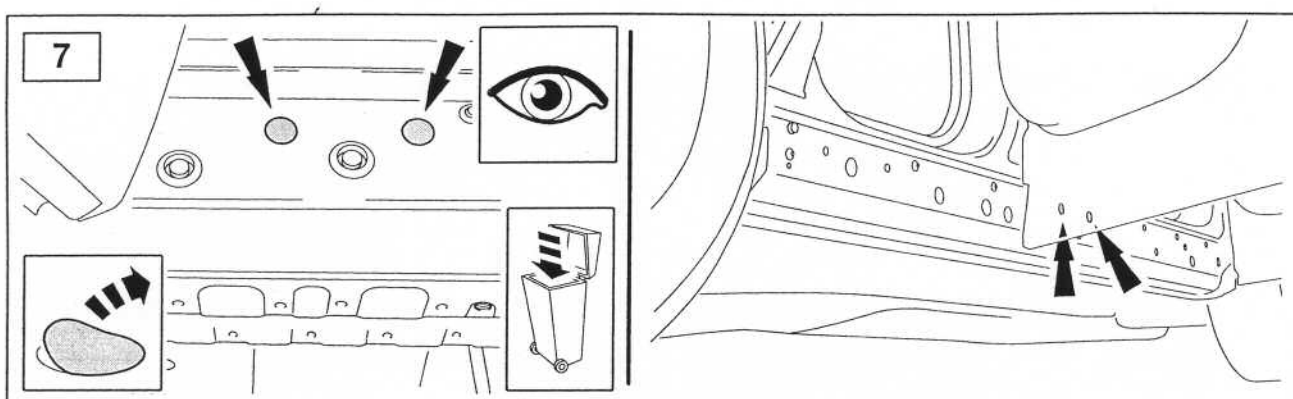
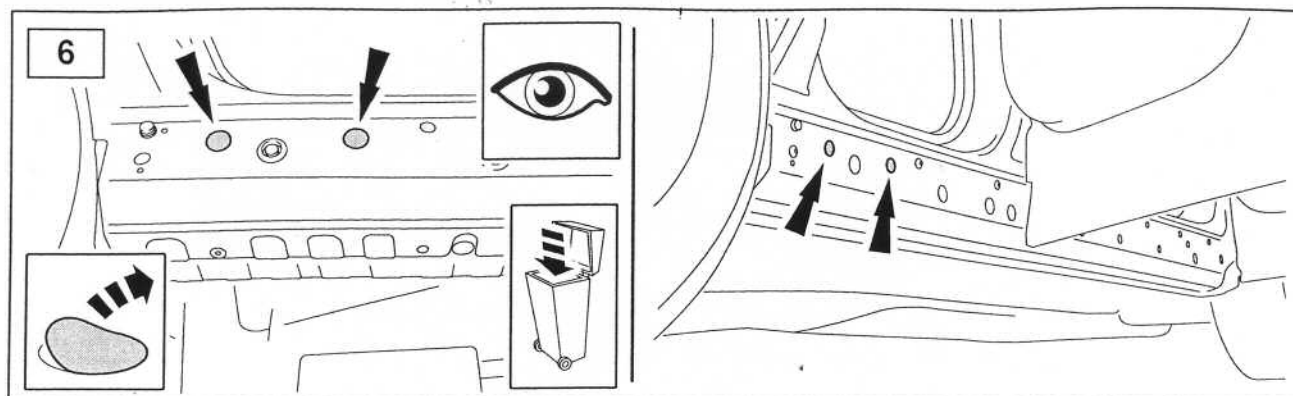

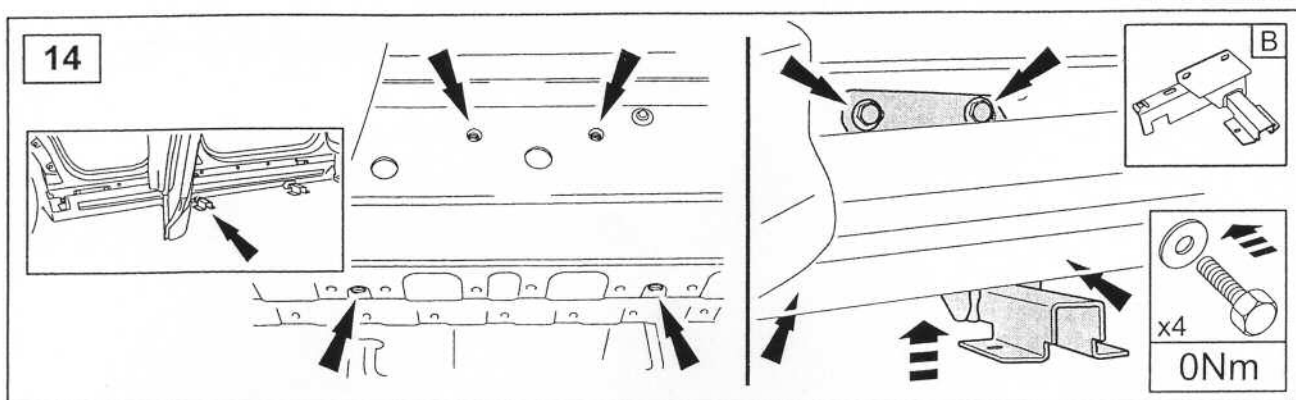
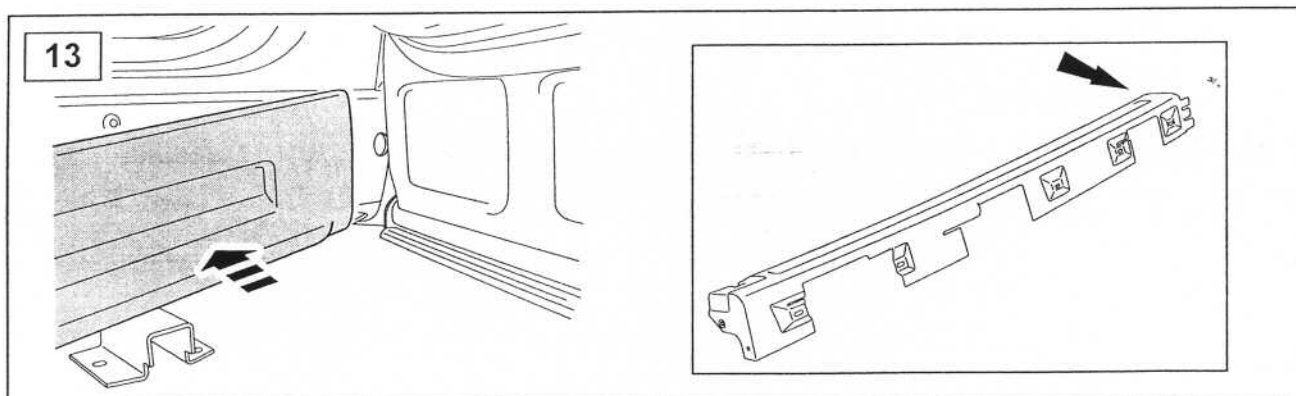
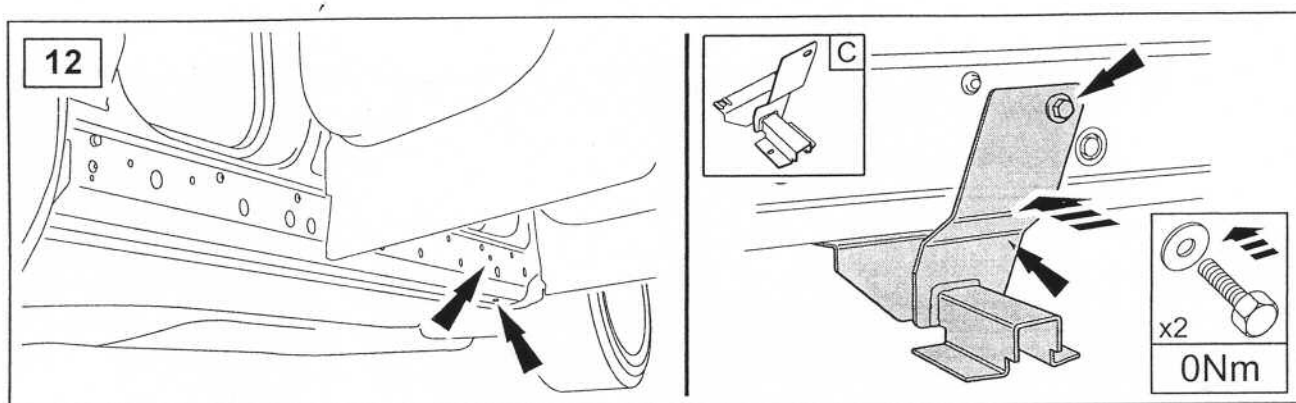
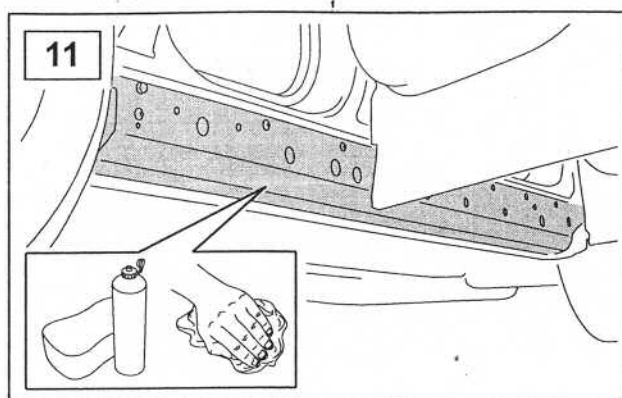

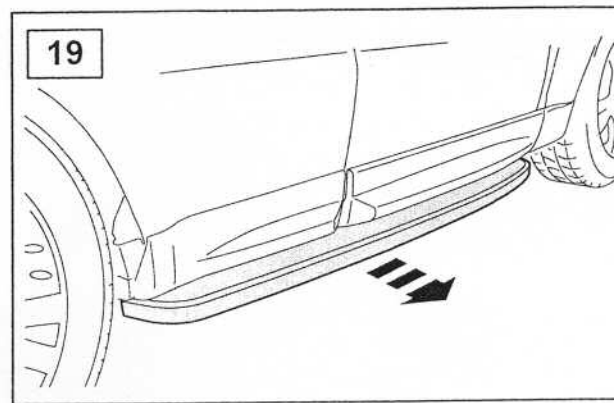
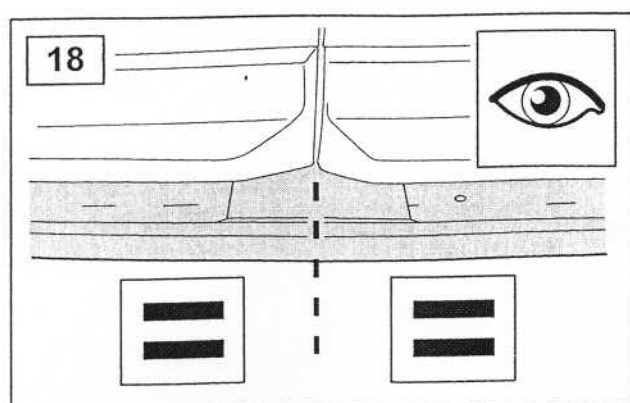
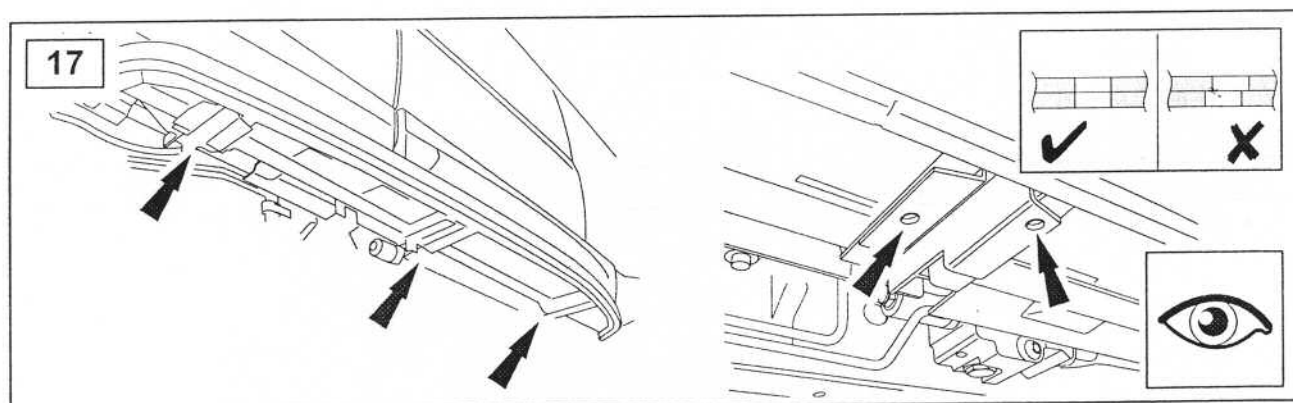
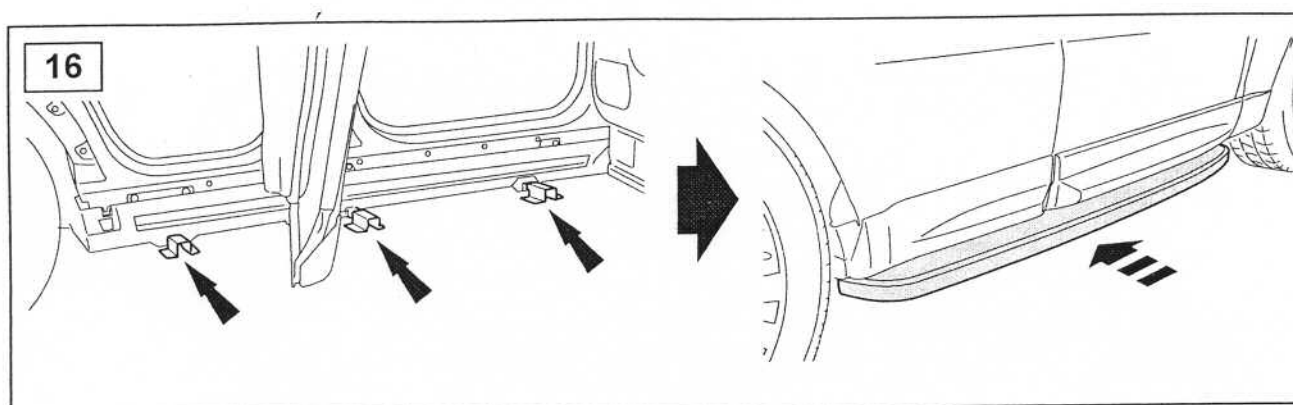
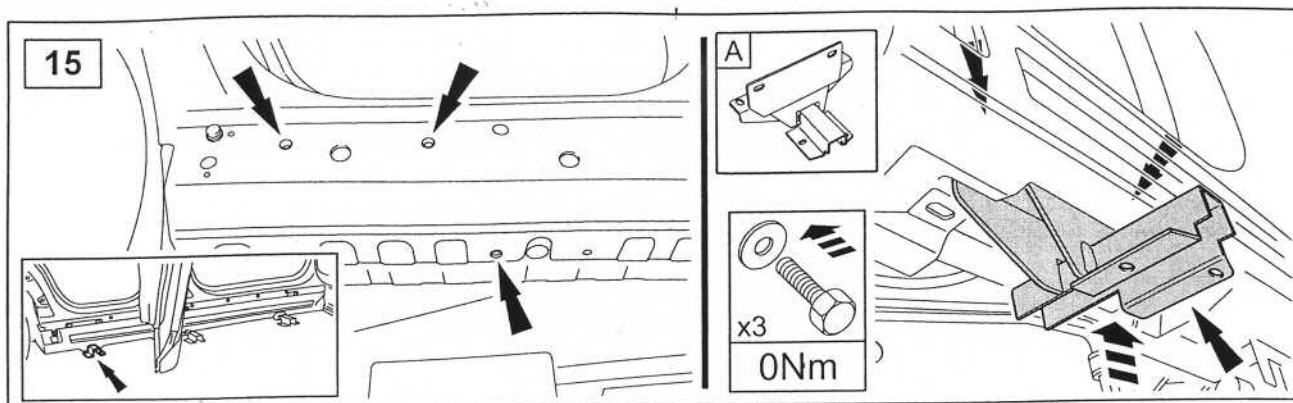

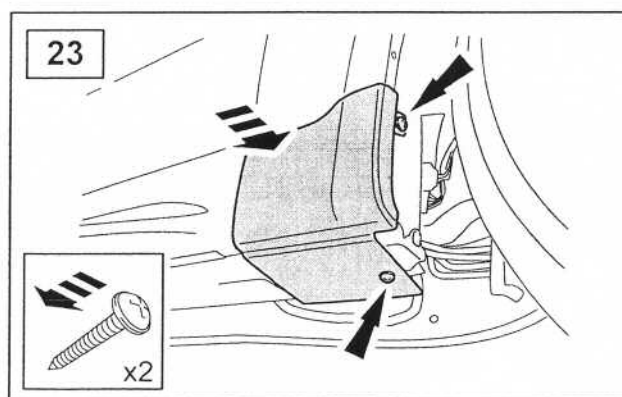
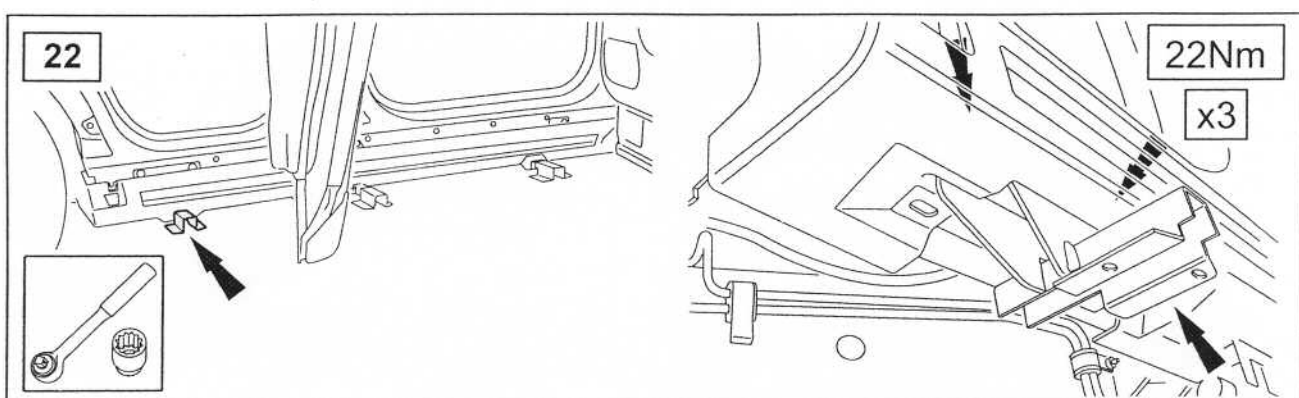
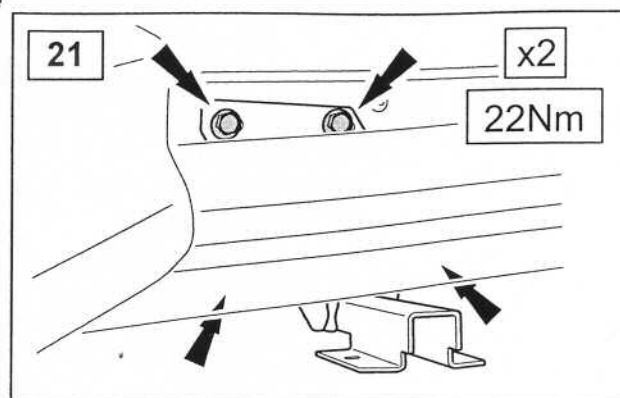
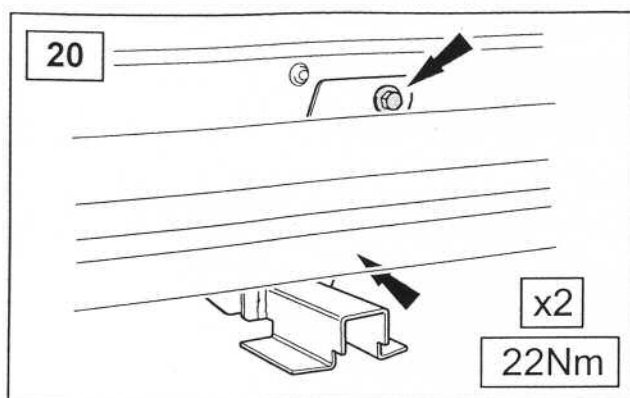

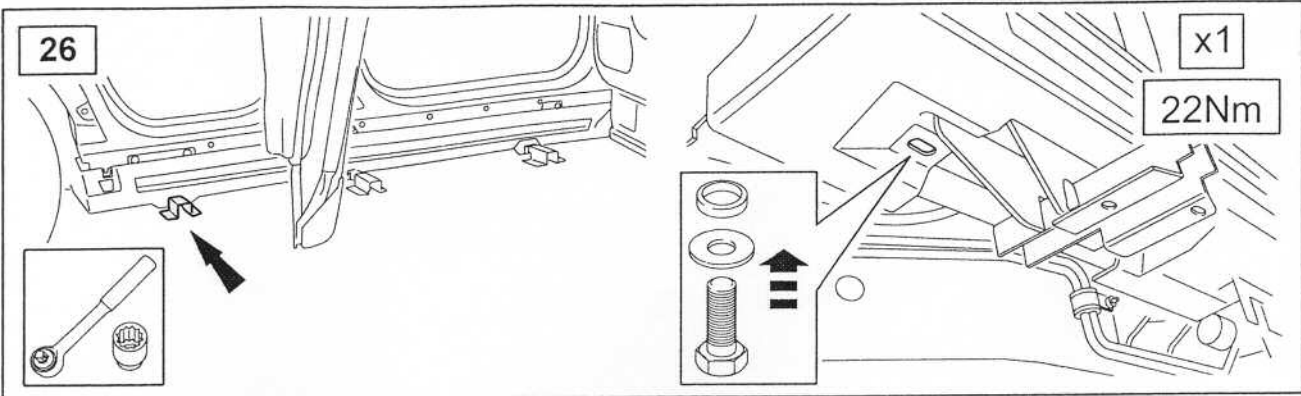
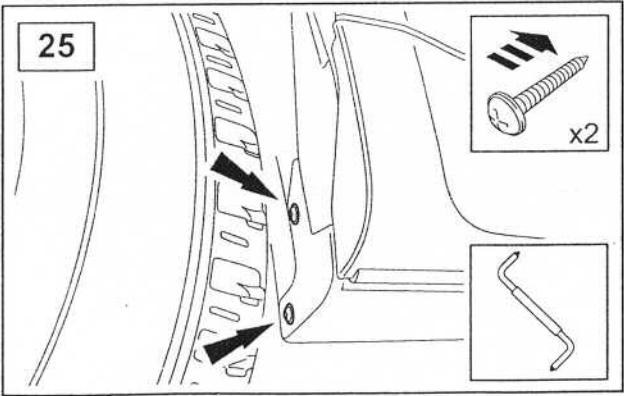
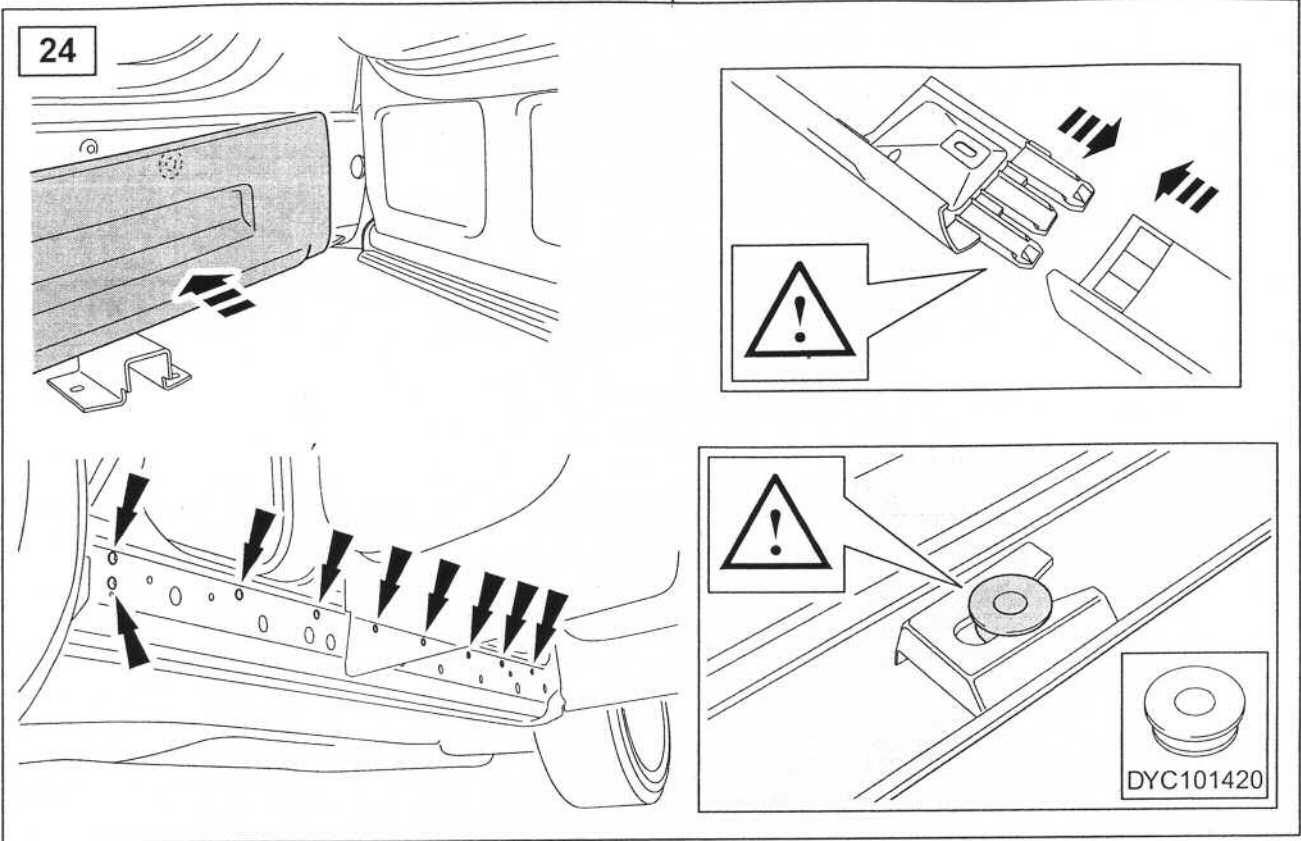

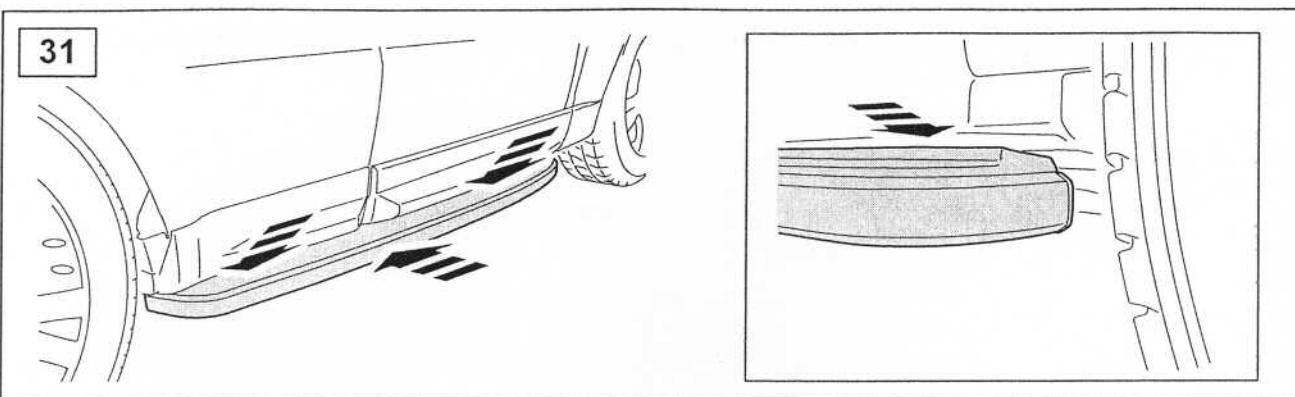
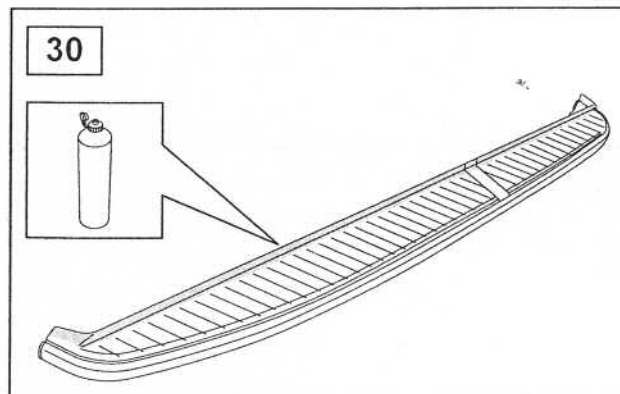
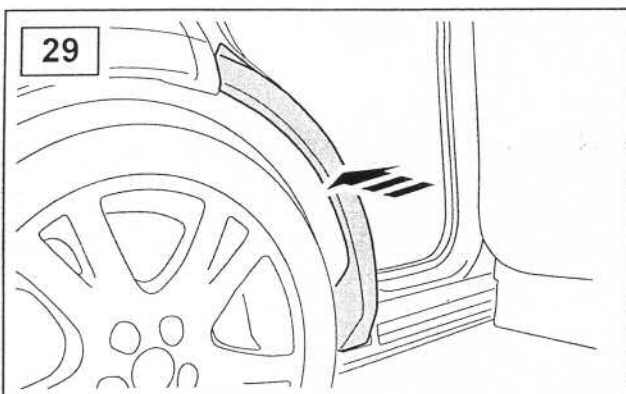
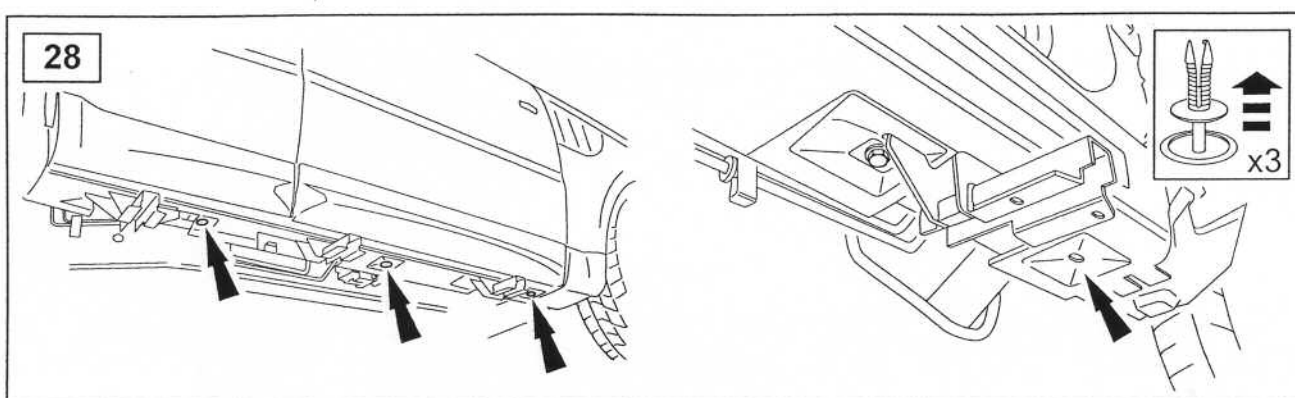
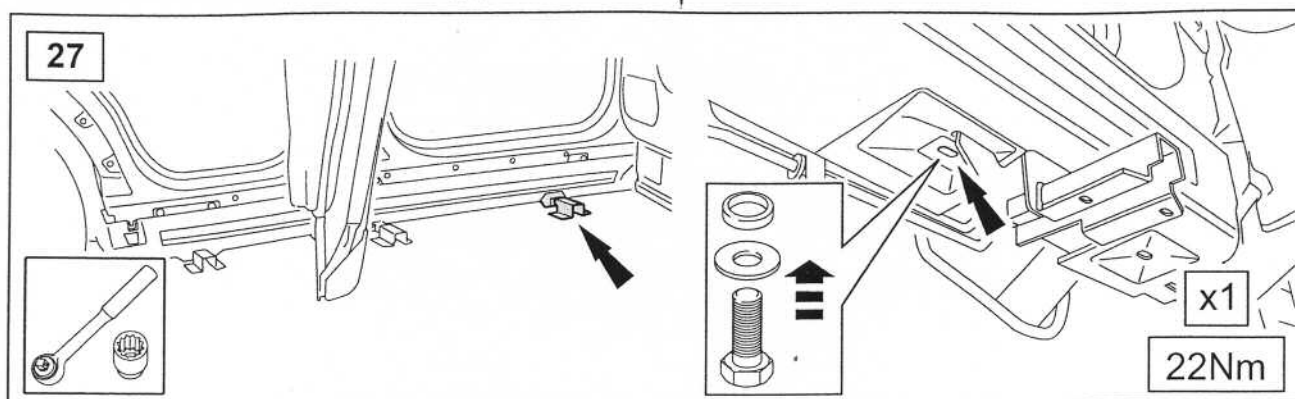

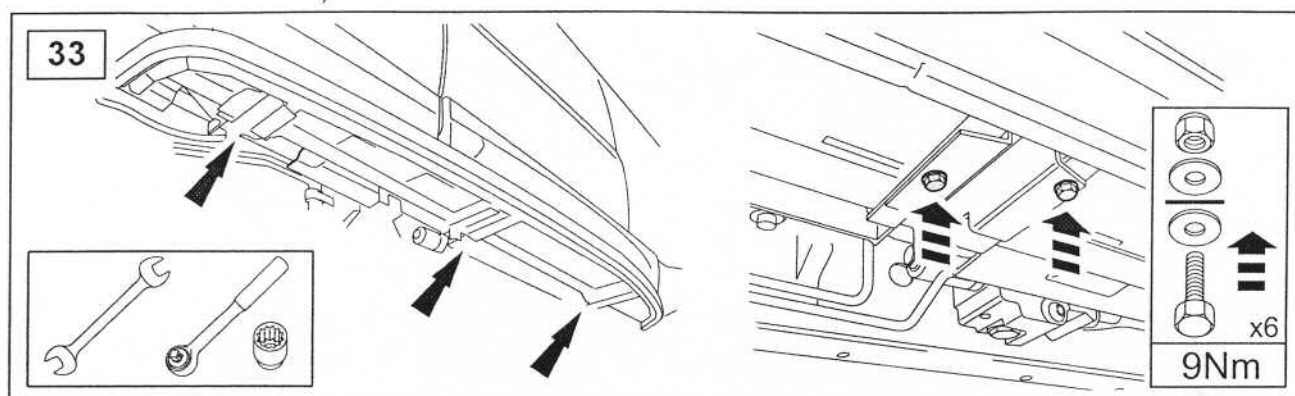
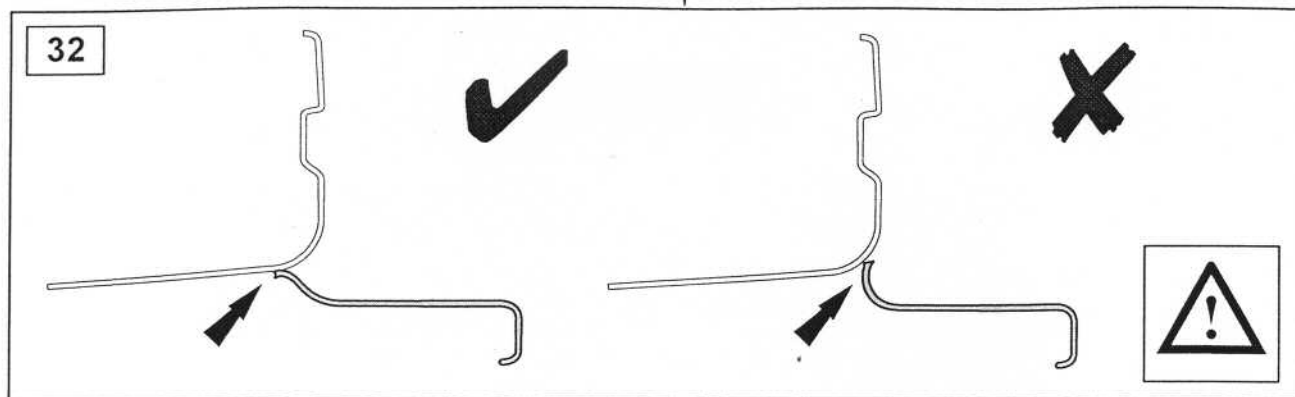

WARNING

Accessories which are not properly fitted can be dangerous.

Read the instructions carefully prior to fitting.

Whilst fitting, comply with the instructions at all times.