

FITTING INSTRUCTIONS

> Discovery



Side Steps

BRITPART

The quality parts for Land Rovers

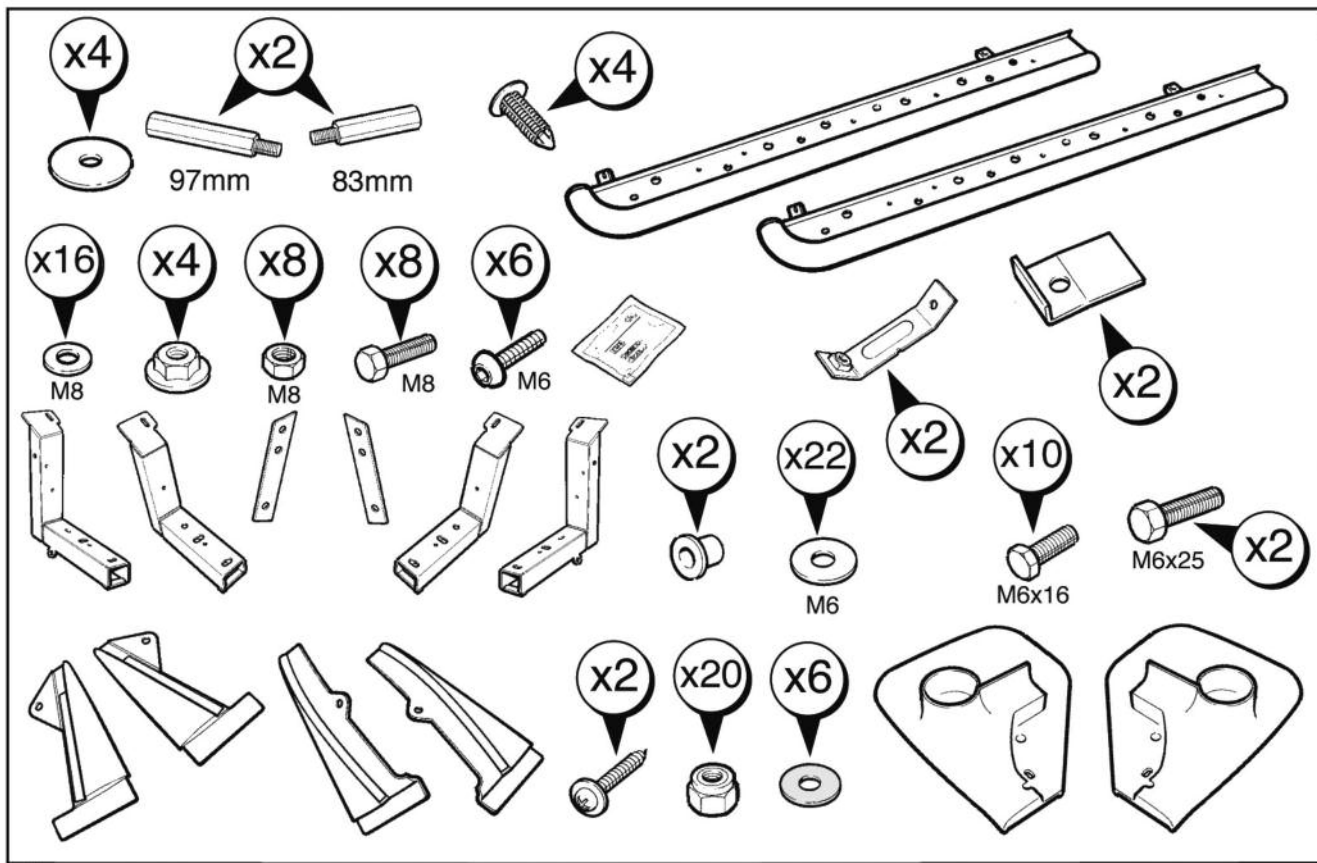

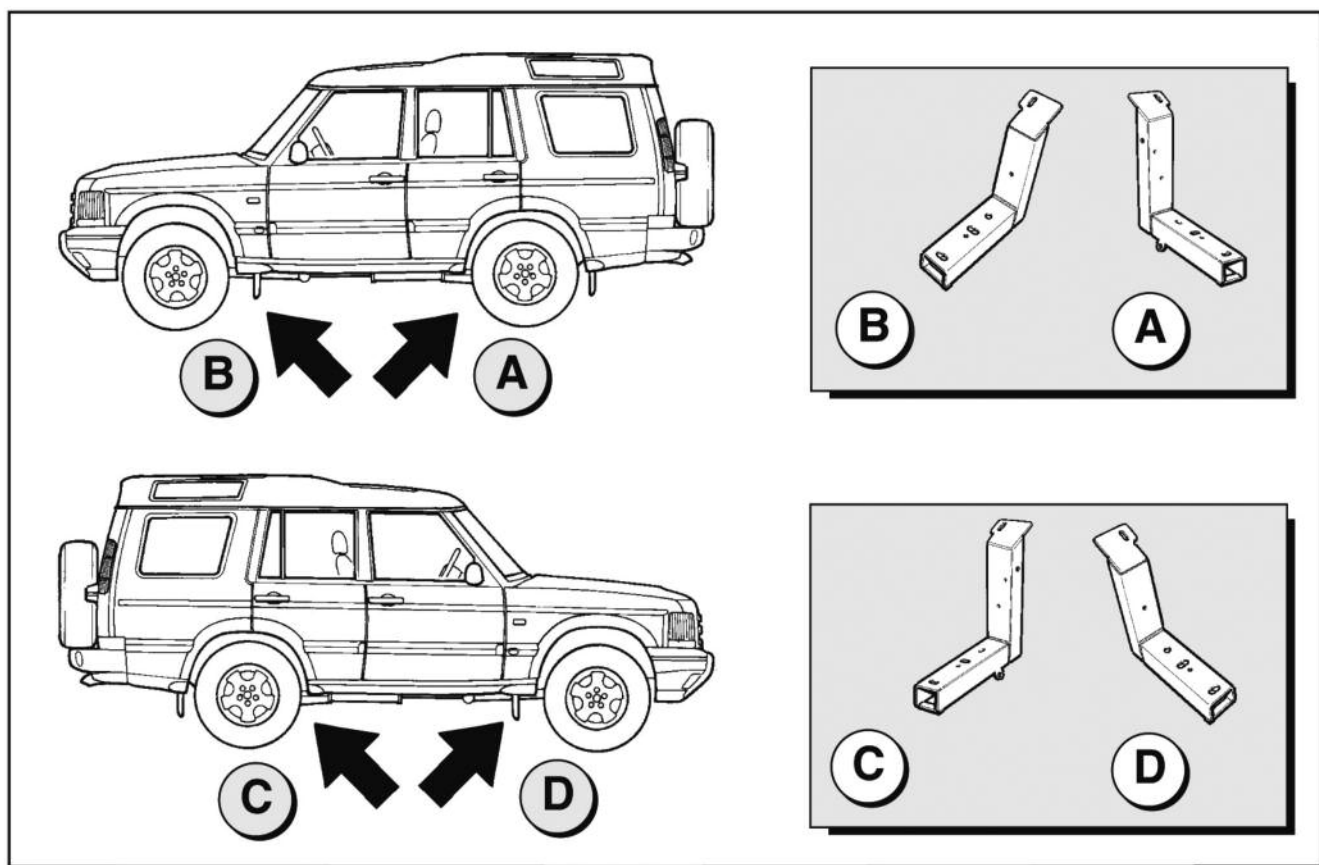

The following instructions are valid for both sides of the vehicle.

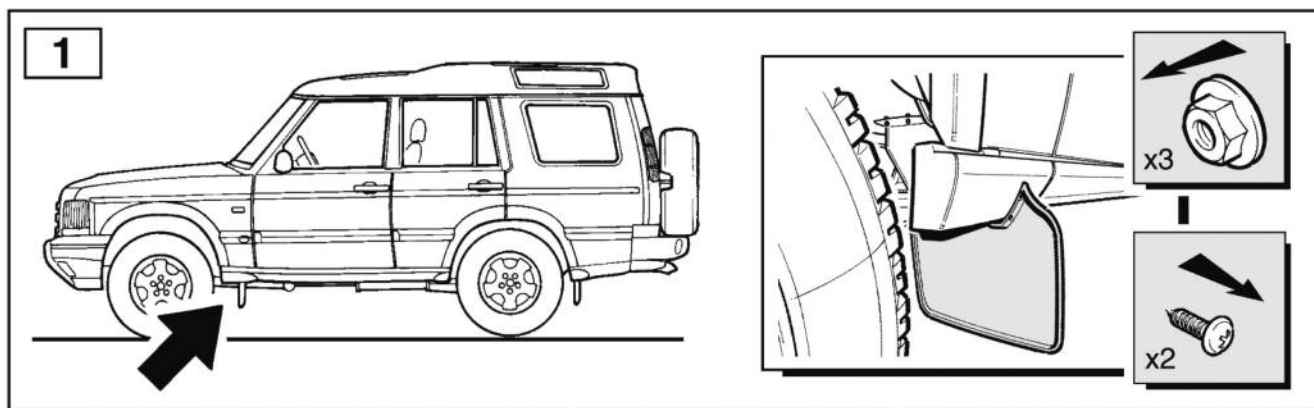
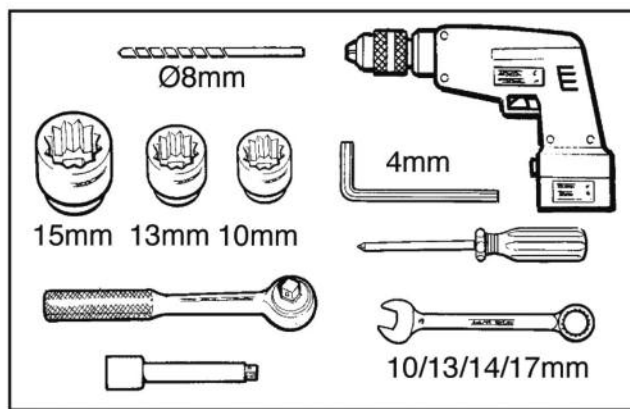

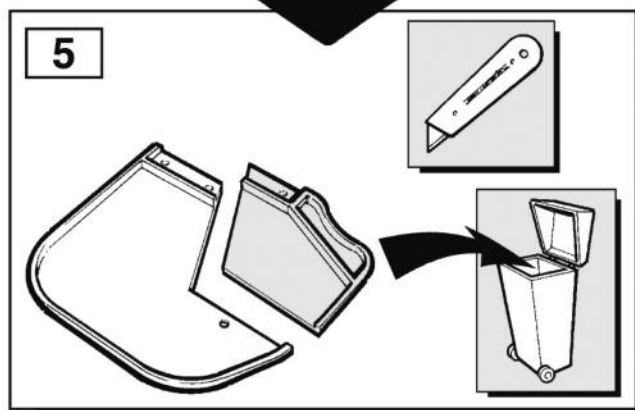
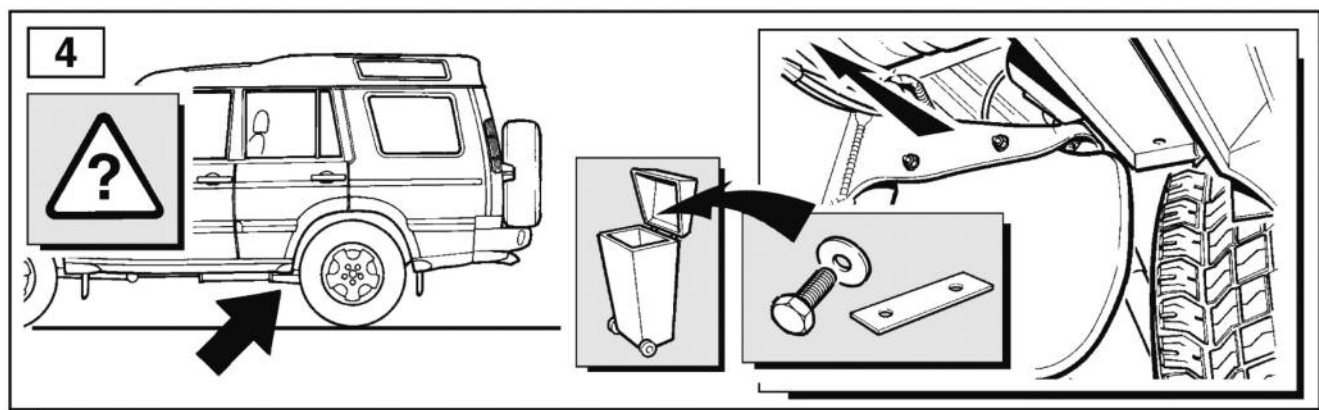
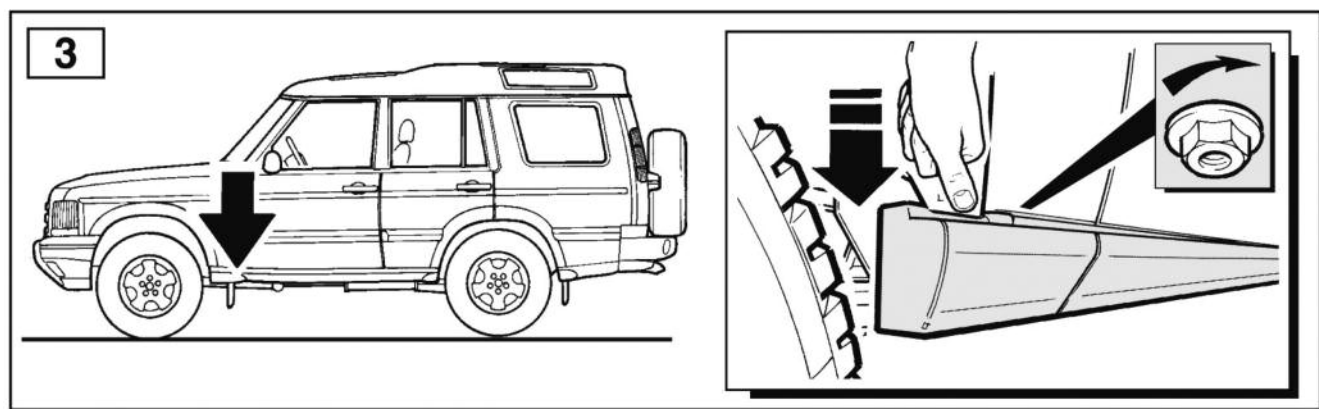
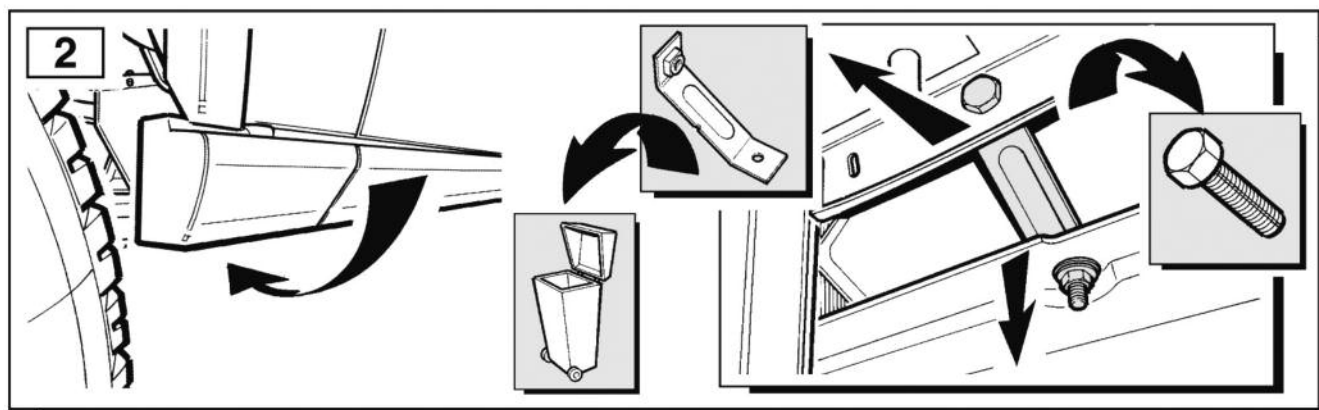

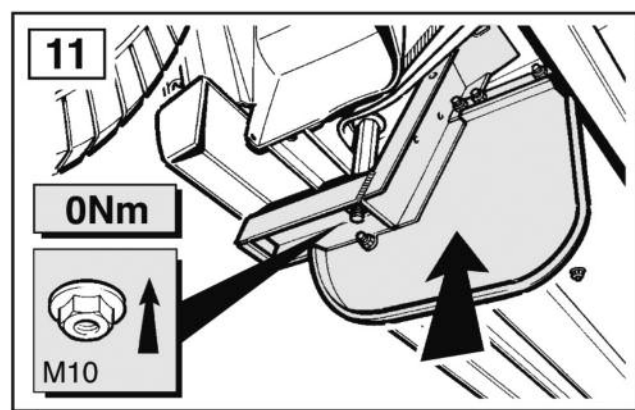
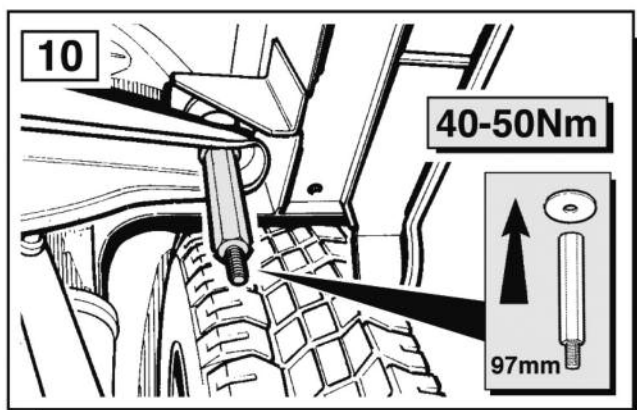
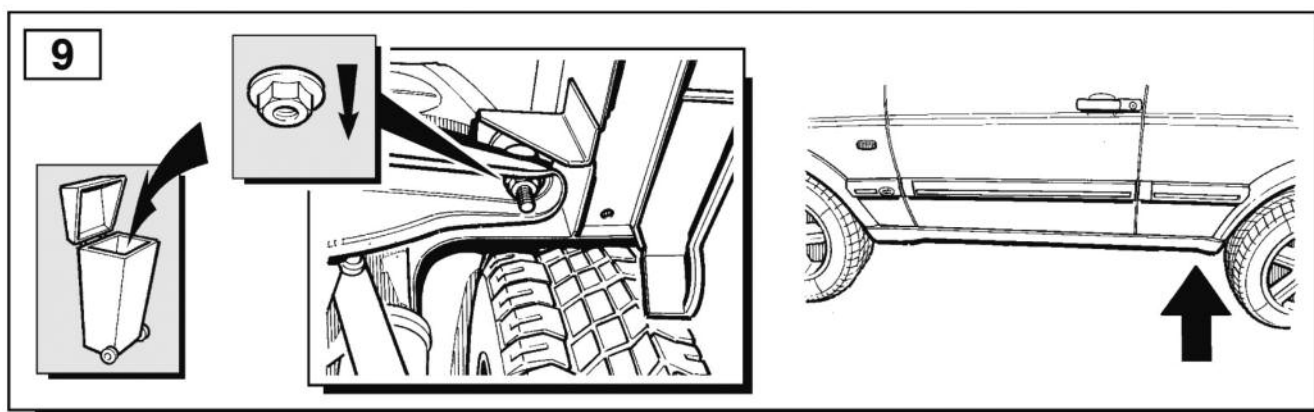
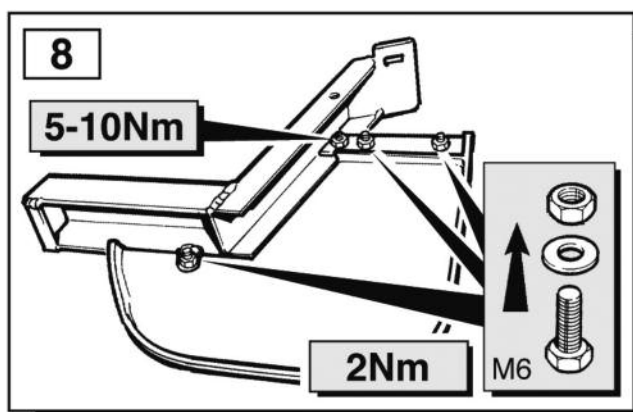
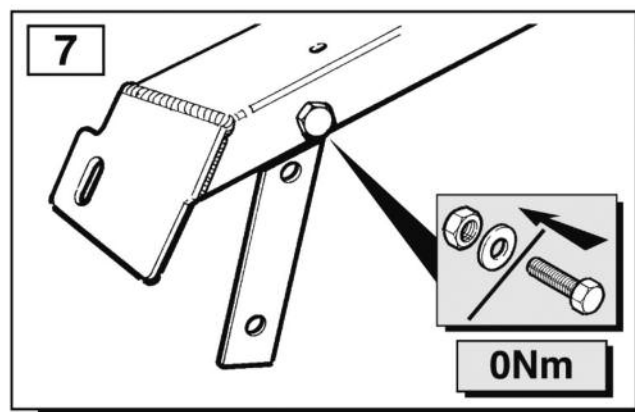
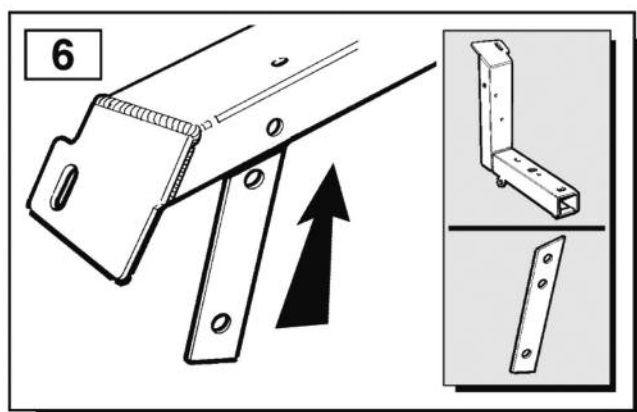

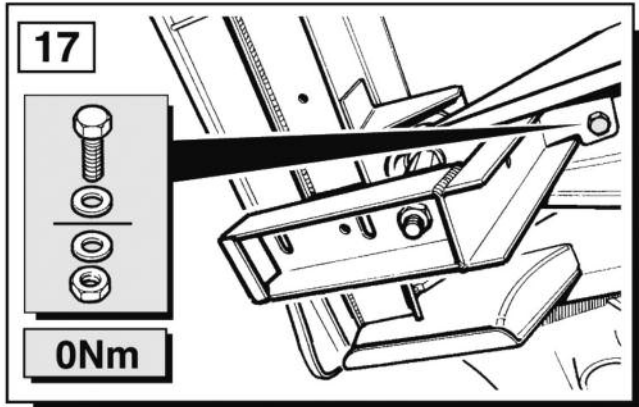
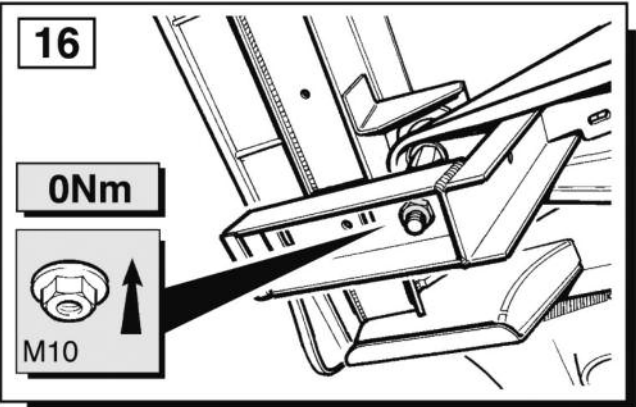
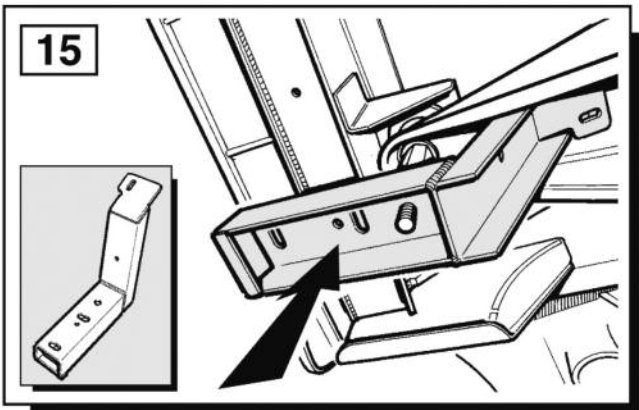
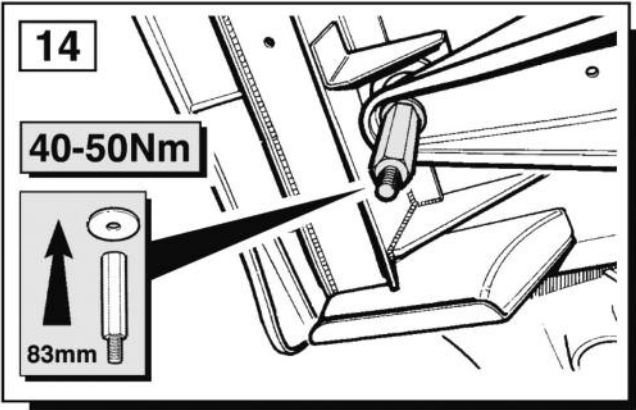
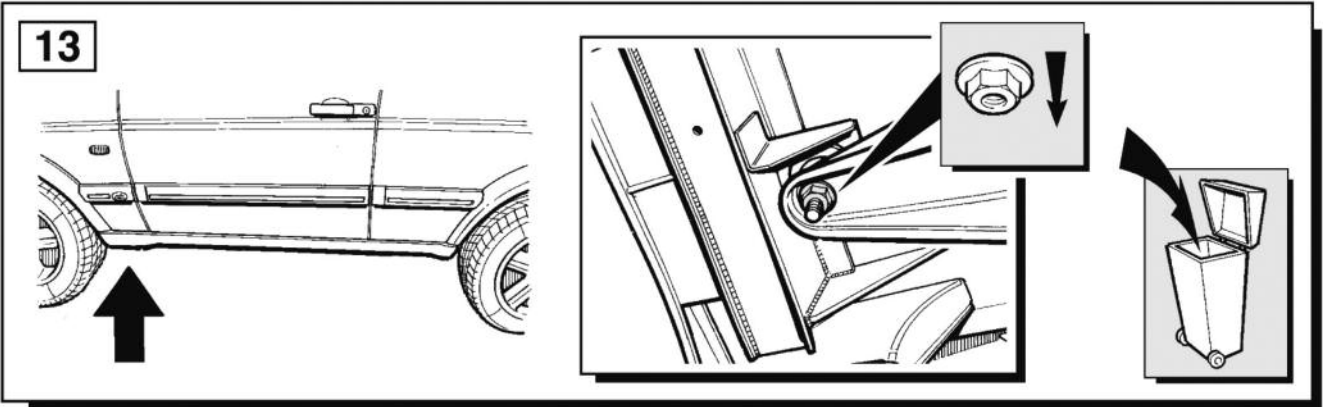
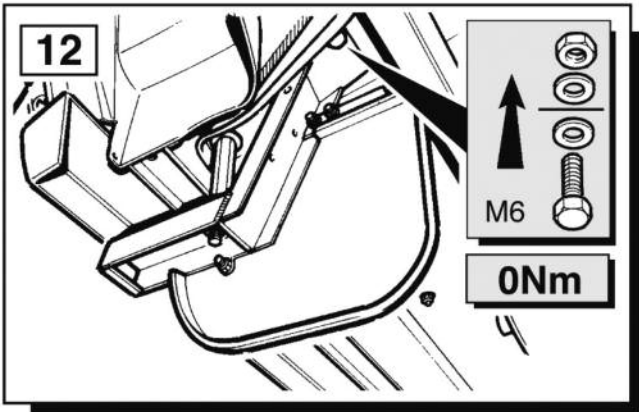

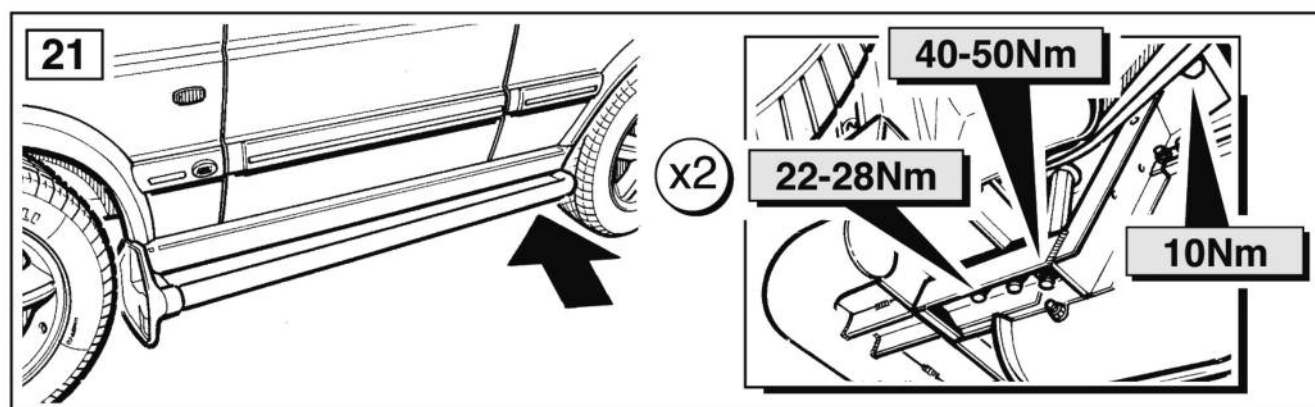
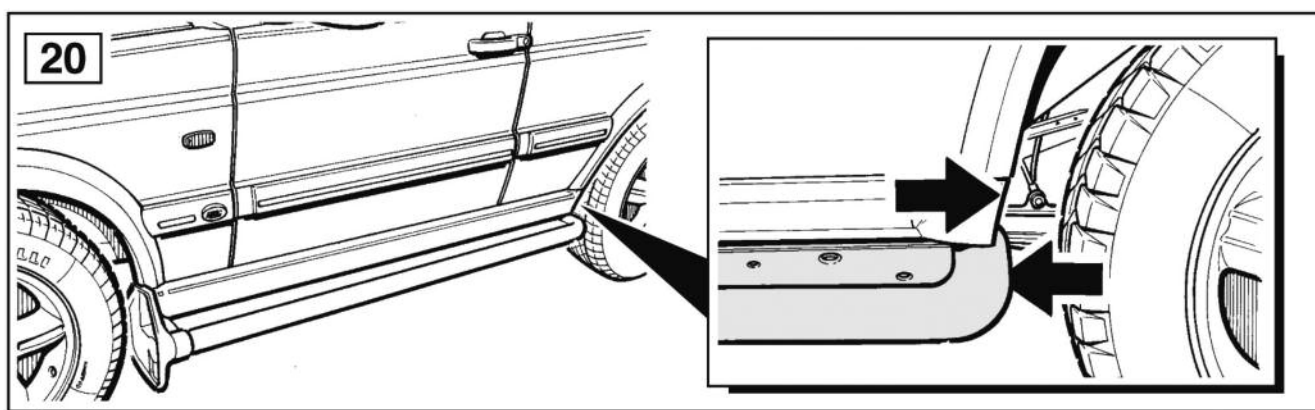
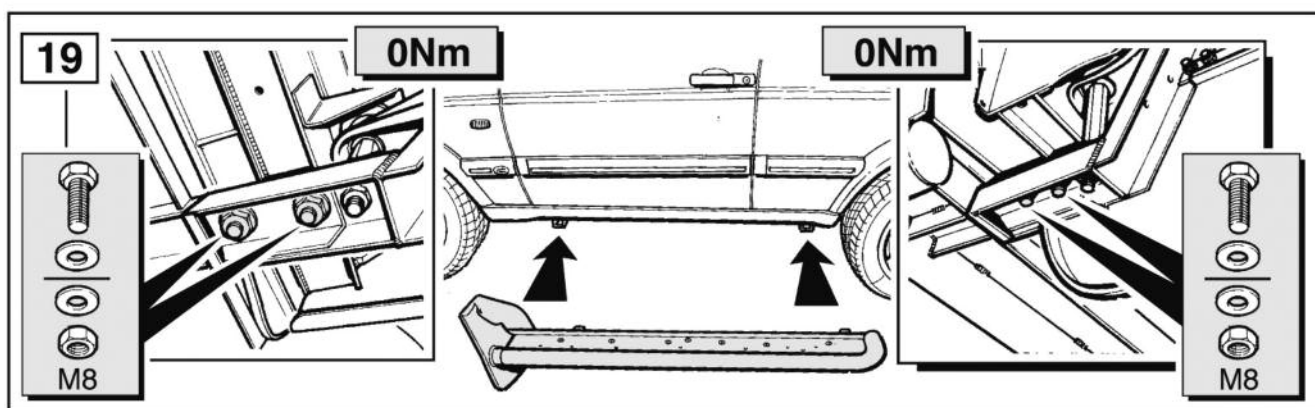
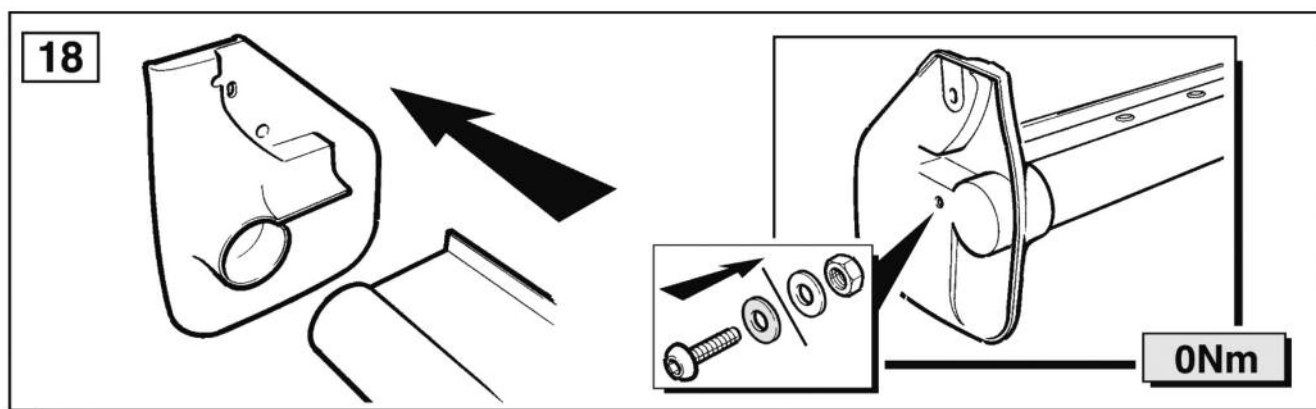

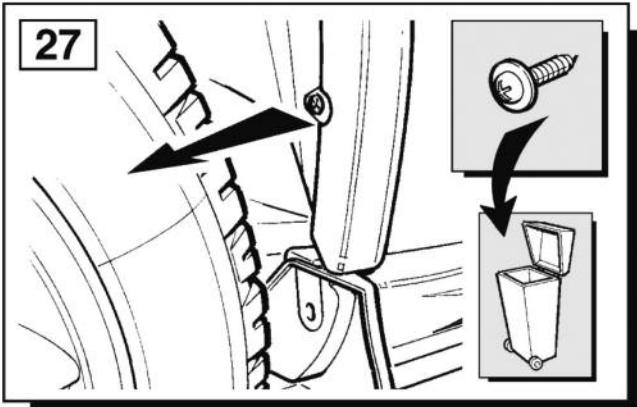
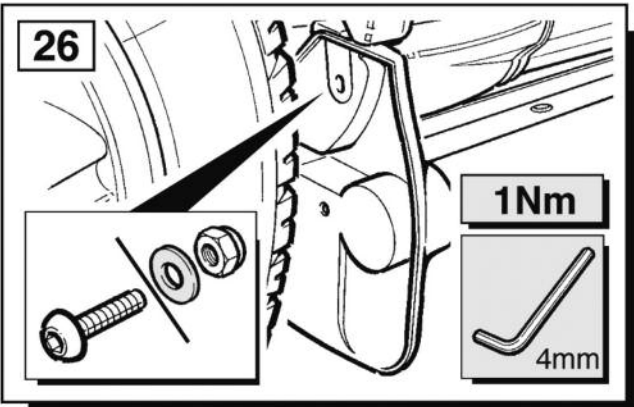
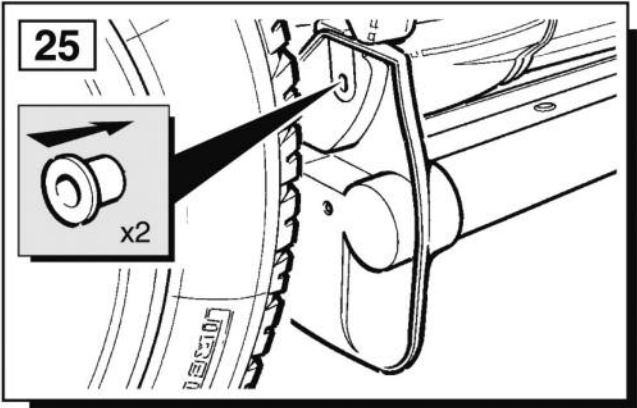
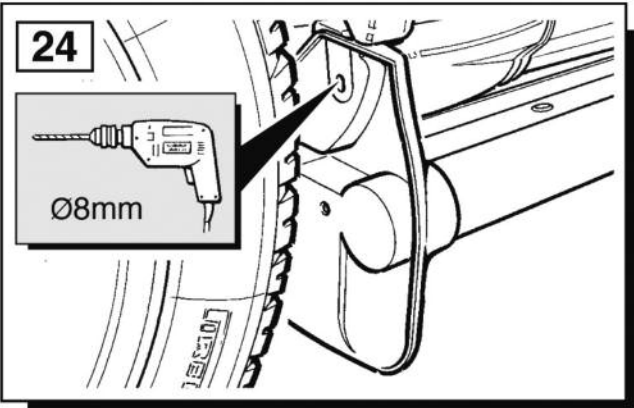
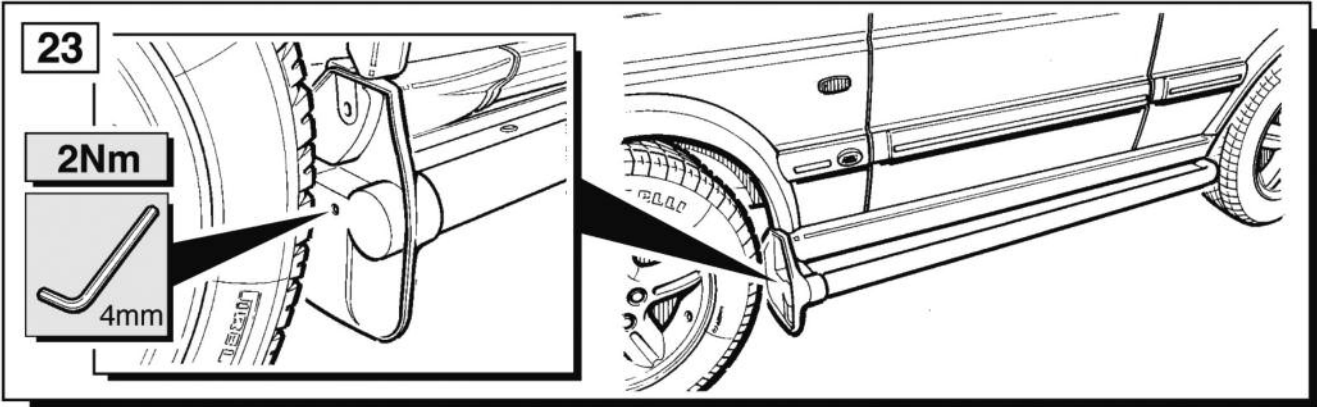
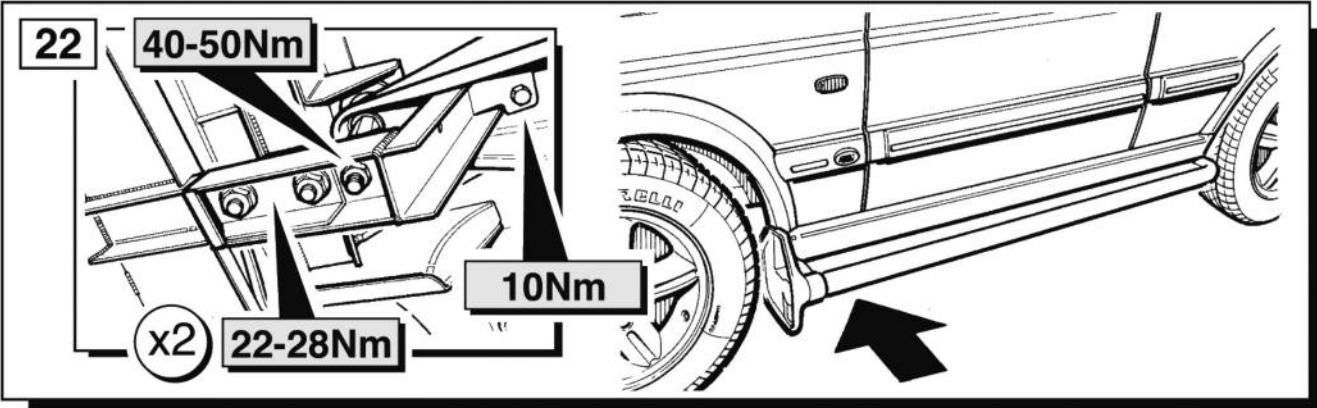

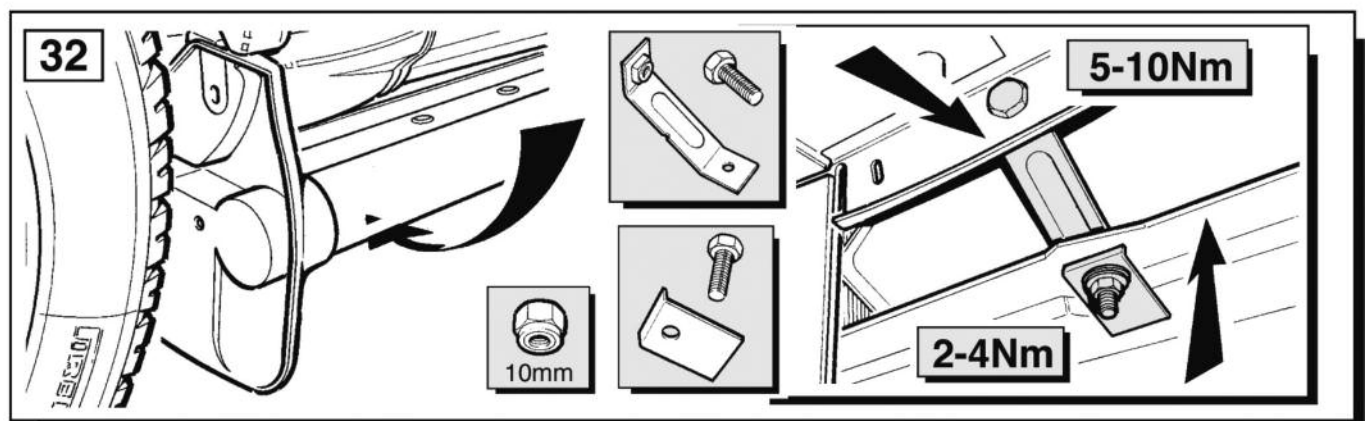
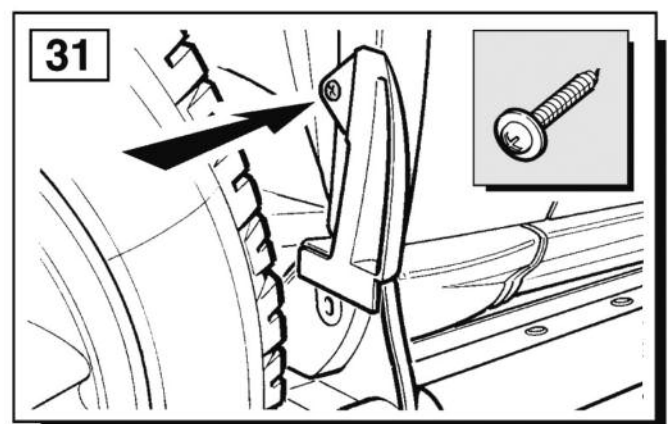
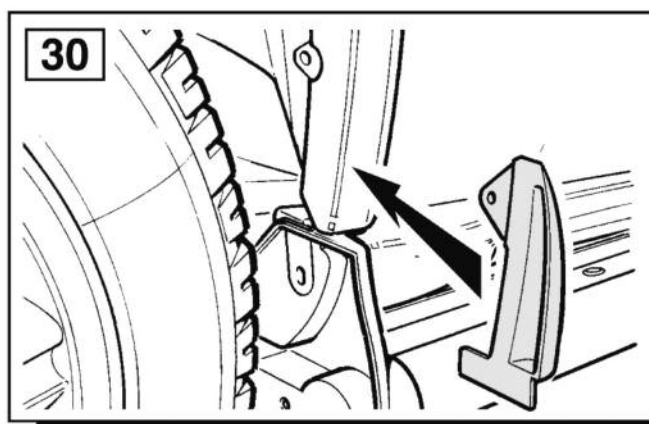
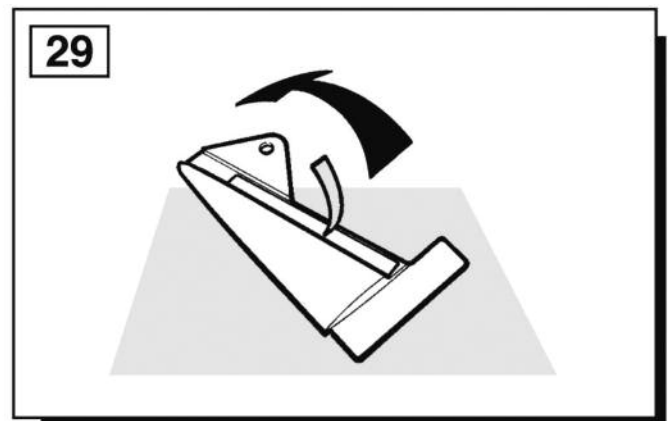
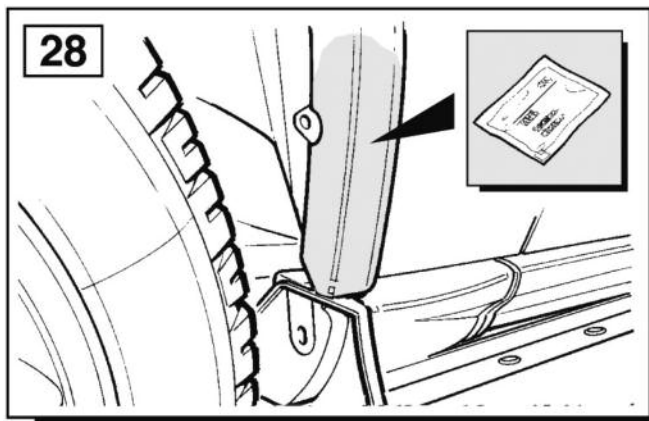

WARNING

Accessories which are not properly fitted can be dangerous.

Read the instructions carefully prior to fitting.

Whilst fitting, comply with the instructions at all times.

**BLANK
PAGE**